

We recommend

## ARCA-SWISS QuickLink

Finally a professional solution that eliminates the tedious fixing of the tripod head.

ARCA-SWISS presents the new tripod mounting QuickLink. The combination of a mounting plate for the tripod and an insert plate which is attached to the tripod head makes attaching and detaching the tripod head child's play. The installed plates can thus be left permanently on the tripod or on the tripod head.

By means of a solid bayonet, the tripod head with its insert plate is placed into the mounting plate and securely fixed by a knurled rotating ring.



## ARCA-SWISS monoball®p1+



### Option for the monoball®p1+

#### Incremental panning ClicPan® (cp)

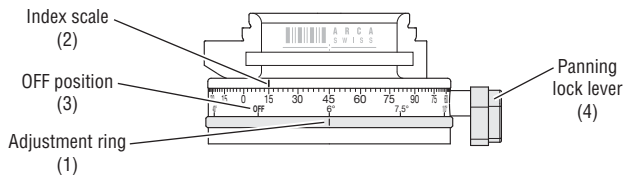

(1) Select a panoramic overlap interval by rotating the white index mark on the clicPan® (brass) adjustment ring. Rotate the ring until the index mark is aligned with your preferred interval detent setting.

Ten positions are provided on the lower scale - 40° (9 stops), 30° (12 stops), 24° (15 stops), 20° (18 stops), 15° (24 stops), 12° (30 stops), 10° (36 stops), 7.5° (48 stops), 6° (60 stops) with an "OFF" position for 360° free panning movement.

The clicPan® adjustment ring will turn in either direction. When rotated, the adjustment ring will stop and "click" into the next detent setting.

Once a setting has been chosen, the mounted camera will pan in equal increments through a 360° radius, with an audible "click" at each position.

(2) The degree of rotation can be visually checked using the upper index scale.  
(3) Move the clicPan® ring to the "OFF" position when 360° free panning is required.

(4) To stop all panning rotation, tighten the upper panning lock lever.  
The upper pan must be unlocked when making incremental panoramic captures using one of the detent settings.

## ARCA-SWISS monoball®p0+



ARCA-SWISS International S.A.R.L.  
29, rue de Châtillon, École Valentin  
FR-25048 Besançon, France  
support@arca-swiss.com  
STD: ++33 381 85 40 60

## ARCA-SWISS monoball®p1+ and p0+

Congratulations on your purchase of the latest monoball®P+ from ARCA-SWISS. The legendary monoball® tripod head series with an aspherical ball.

Please note that the knurled wheel to lock the monoball® does need some vertical play to function properly!  
Your monoball®p+ needs no maintenance and will serve you for many years. If the monoball® is not moving as smoothly, clean the ball with a soft cloth and alcohol. However, please make sure that sand and dust do not enter the housing.

DO NOT USE ANY LUBRICANTS as this would impair proper function!

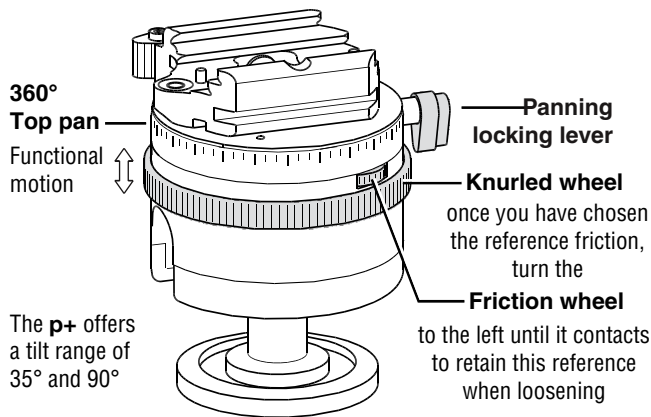

## User manual - new friction unit

The knurled wheel is used to lock the ball into position, to set any specific friction and the minimum friction according to individual requirement. If the knurled wheel is turned clockwise, the friction increases and eventually will lock the ball into position. In order to loosen the ball, turn the friction wheel counter-clockwise. Please note: Do not attempt to force the knurled wheel beyond the minimum friction, as this can block the wheel. If you wish to alter the minimum friction (e.g. for regular use of heavier cameras), turn the knurled wheel until the desired minimum friction is obtained and direct the friction wheel clockwise down to the stop with your thumb. The knurled wheel can now no longer be loosened beyond this point. If more than one camera is to be used on your monoball®, set the minimum friction to match the lightest camera and turn the scale to the zero position.

### ATTENTION !

Do not force the knurled wheel backwards, (counter-clockwise) as this may lead to a freeze-up of the ball.

To correct this, turn the knurled wheel forwards (clockwise) then back out the friction wheel counterclockwise and re-loosen the knurled wheel counterclockwise.

When friction wheel is engaged, the knurled wheel will not loosen past set friction point.

## ARCA-SWISS quick release device

All tripod heads from ARCA-SWISS are available with a choice of quick release: Classic, flipLock® and monoball®Fix. The Classic and flipLock® systems are equipped with a double dovetail so that you can fit the classic camera plates in the upper dovetail and the monoball®Fix to the bottom. The Fix system is compatible with the monoball®Fix plates. All three of them are compatible with the monorails of the ARCA-SWISS cameras.

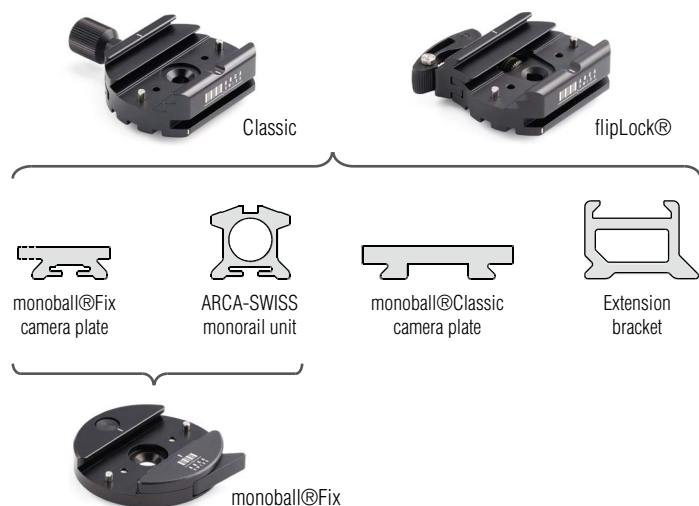

## flipLock® instructions :

The ARCA-SWISS flipLock® quick release allows the use of the (most common) ARCA-SWISS "classic" camera plates, thanks to the two levels, all camera plates are also compatible with the new standard monoball®Fix.

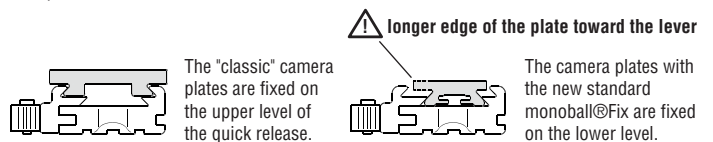

The ARCA-SWISS flipLock® quick release offers an adjustment option that adapt to various camera plates that comply with the "ARCA-SWISS standard". Tolerances may vary from brand to brand.

The ARCA-SWISS quick release flipLock® offers 3 positions:

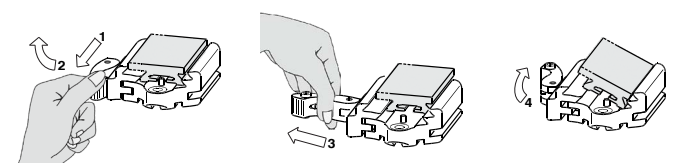
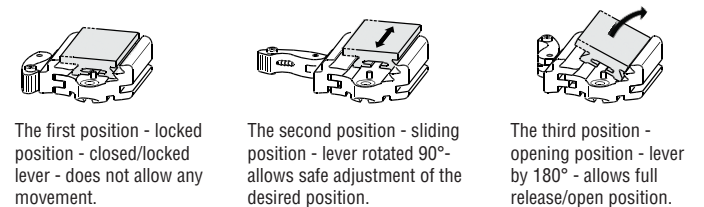

The change from one position to the other is performed as follows:

1. Pull the release button towards you between your thumb and forefinger.
2. Then turn the lever 90° to the stop.

To change from the sliding position to the open position:

3. Push the serrated pin outward with a press of your thumb.
4. Then swivel the lever until it is fully open.

## monoball®Fix instructions :

1. Open by pulling the clamping lever with your thumb
2. Insert the cameraplate (side opposite the clamping lever)
3. if necessary, center the cameraplate
4. **important:** lock by **clicking** on the clamping lever !

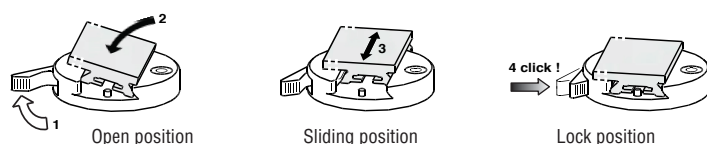

## Quickset device Classic instructions :

To open, turn the knob counterclockwise.  
To close, turn the knob clockwise.